



St Edmundsbury
Application for a premises licence
Licensing Act 2003

For help contact
licensing@westsuffolk.gov.uk
 Telephone: 01284 757400

* required information

Section 1 of 19

You can save the form at any time and resume it later. You do not need to be logged in when you resume.

System reference This is the unique reference for this application generated by the system.

Your reference You can put what you want here to help you track applications if you make lots of them. It is passed to the authority.

Are you an agent acting on behalf of the applicant?

- Yes No

Put "no" if you are applying on your own behalf or on behalf of a business you own or work for.

Applicant Details

* First name

* Family name

* E-mail

Main telephone number Include country code.

Other telephone number

Indicate here if the applicant would prefer not to be contacted by telephone

Is the applicant:

- Applying as a business or organisation, including as a sole trader
 Applying as an individual

A sole trader is a business owned by one person without any special legal structure. Applying as an individual means the applicant is applying so the applicant can be employed, or for some other personal reason, such as following a hobby.

Applicant Business

* Is the applicant's business registered in the UK with Companies House? Yes No

* Registration number

* Business name If the applicant's business is registered, use its registered name.

* VAT number Put "none" if the applicant is not registered for VAT.

* Legal status

Continued from previous page...

* Applicant's position in the business

Home country

The country where the applicant's headquarters are.

Registered Address

Address registered with Companies House.

* Building number or name

* Street

District

* City or town

County or administrative area

* Postcode

* Country

Agent Details

* First name

* Family name

* E-mail

Main telephone number

Include country code.

Other telephone number

Indicate here if you would prefer not to be contacted by telephone

Are you:

An agent that is a business or organisation, including a sole trader

A sole trader is a business owned by one person without any special legal structure.

A private individual acting as an agent

Agent Business

* Is your business registered in the UK with Companies House? Yes No

* Registration number

* Business name

If your business is registered, use its registered name.

* VAT number

Put "none" if you are not registered for VAT.

* Legal status

Continued from previous page...

* Your position in the business

Home country

The country where the headquarters of your business is located.

Agent Registered Address

Address registered with Companies House.

* Building number or name

* Street

District

* City or town

County or administrative area

* Postcode

* Country

Section 2 of 19

PREMISES DETAILS

I/we, as named in section 1, apply for a premises licence under section 17 of the Licensing Act 2003 for the premises described in section 2 below (the premises) and I/we are making this application to you as the relevant licensing authority in accordance with section 12 of the Licensing Act 2003.

Premises Address

Are you able to provide a postal address, OS map reference or description of the premises?

Address OS map reference Description

Postal Address Of Premises

Building number or name

Street

District

City or town

County or administrative area

Postcode

Country

Further Details

Telephone number

Non-domestic rateable value of premises (£)

Section 3 of 19

APPLICATION DETAILS

In what capacity are you applying for the premises licence?

- An individual or individuals
- A limited company
- A partnership
- An unincorporated association
- A recognised club
- A charity
- The proprietor of an educational establishment
- A health service body
- A person who is registered under part 2 of the Care Standards Act 2000 (c14) in respect of an independent hospital in Wales
- A person who is registered under Chapter 2 of Part 1 of the Health and Social Care Act 2008 in respect of the carrying on of a regulated activity (within the meaning of that Part) in an independent hospital in England
- The chief officer of police of a police force in England and Wales
- Other (for example a statutory corporation)

Confirm The Following

- I am carrying on or proposing to carry on a business which involves the use of the premises for licensable activities
- I am making the application pursuant to a statutory function
- I am making the application pursuant to a function discharged by virtue of Her Majesty's prerogative

Section 4 of 19

NON INDIVIDUAL APPLICANTS

Provide name and registered address of applicant in full. Where appropriate give any registered number. In the case of a partnership or other joint venture (other than a body corporate), give the name and address of each party concerned.

Non Individual Applicant's Name

Name

Details

Registered number (where applicable)

Description of applicant (for example partnership, company, unincorporated association etc)

Continued from previous page...

Address

Building number or name

Street

District

City or town

County or administrative area

Postcode

Country

Contact Details

E-mail

Telephone number

Other telephone number

Section 5 of 19

OPERATING SCHEDULE

When do you want the premises licence to start? / /
dd mm yyyy

If you wish the licence to be valid only for a limited period, when do you want it to end / /
dd mm yyyy

Provide a general description of the premises

For example the type of premises, its general situation and layout and any other information which could be relevant to the licensing objectives. Where your application includes off-supplies of alcohol and you intend to provide a place for consumption of these off-supplies you must include a description of where the place will be and its proximity to the premises.

Fast Food Restaurant

If 5,000 or more people are expected to attend the premises at any one time, state the number expected to attend

Continued from previous page..

Section 6 of 19

PROVISION OF PLAYS

Will you be providing plays?

Yes No

Section 7 of 19

PROVISION OF FILMS

Will you be providing films?

Yes No

Section 8 of 19

PROVISION OF INDOOR SPORTING EVENTS

Will you be providing indoor sporting events?

Yes No

Section 9 of 19

PROVISION OF BOXING OR WRESTLING ENTERTAINMENTS

Will you be providing boxing or wrestling entertainments?

Yes No

Section 10 of 19

PROVISION OF LIVE MUSIC

Will you be providing live music?

Yes No

Section 11 of 19

PROVISION OF RECORDED MUSIC

Will you be providing recorded music?

Yes No

Section 12 of 19

PROVISION OF PERFORMANCES OF DANCE

Will you be providing performances of dance?

Yes No

Section 13 of 19

PROVISION OF ANYTHING OF A SIMILAR DESCRIPTION TO LIVE MUSIC, RECORDED MUSIC OR PERFORMANCES OF DANCE

Will you be providing anything similar to live music, recorded music or performances of dance?

Yes No

Section 14 of 19

LATE NIGHT REFRESHMENT

Will you be providing late night refreshment?

Section 15 of 19

SUPPLY OF ALCOHOL

Will you be selling or supplying alcohol?

Yes

No

Standard Days And Timings

MONDAY

Start 10:00

End 23:00

Start

End

Give timings in 24 hour clock. (e.g., 16:00) and only give details for the days of the week when you intend the premises to be used for the activity.

TUESDAY

Start 10:00

End 23:00

Start

End

WEDNESDAY

Start 10:00

End 23:00

Start

End

THURSDAY

Start 10:00

End 23:00

Start

End

FRIDAY

Start 10:00

End 23:00

Start

End

SATURDAY

Start 10:00

End 23:00

Start

End

SUNDAY

Start 10:00

End 23:00

Start

End

Will the sale of alcohol be for consumption:

On the premises

Off the premises

Both

If the sale of alcohol is for consumption on the premises select on, if the sale of alcohol is for consumption away from the premises select off, if the sale of alcohol is for consumption on the premises and away from the premises select both.

State any seasonal variations

For example (but not exclusively) where the activity will occur on additional days during the summer months.

Continued from previous page...

Non-standard timings. Where the premises will be used for the supply of alcohol at different times from those listed in the column on the left, list below

For example (but not exclusively), where you wish the activity to go on longer on a particular day e.g. Christmas Eve.

State the name and details of the individual whom you wish to specify on the licence as premises supervisor

Name

First name

Family name

Enter the contact's address

Building number or name

Street

District

City or town

County or administrative area

Postcode

Country

Personal Licence number (if known)

Issuing licensing authority (if known)

PROPOSED DESIGNATED PREMISES SUPERVISOR CONSENT

How will the consent form of the proposed designated premises supervisor be supplied to the authority?

- Electronically, by the proposed designated premises supervisor
- As an attachment to this application

Reference number for consent form (if known)

If the consent form is already submitted, ask the proposed designated premises supervisor for its 'system reference' or 'your reference'.

Continued from previous page...

Section 16 of 19

ADULT ENTERTAINMENT

Highlight any adult entertainment or services, activities, or other entertainment or matters ancillary to the use of the premises that may give rise to concern in respect of children

Give information about anything intended to occur at the premises or ancillary to the use of the premises which may give rise to concern in respect of children, regardless of whether you intend children to have access to the premises, for example (but not exclusively) nudity or semi-nudity, films for restricted age groups etc gambling machines etc.

Section 17 of 19

HOURS PREMISES ARE OPEN TO THE PUBLIC

Standard Days And Timings

MONDAY

Start

End

Start

End

Give timings in 24 hour clock.
(e.g., 16:00) and only give details for the days
of the week when you intend the premises
to be used for the activity.

TUESDAY

Start

End

Start

End

WEDNESDAY

Start

End

Start

End

THURSDAY

Start

End

Start

End

FRIDAY

Start

End

Start

End

SATURDAY

Start

End

Start

End

SUNDAY

Start

End

Start

End

State any seasonal variations

Continued from previous page...

For example (but not exclusively) where the activity will occur on additional days during the summer months.

Non standard timings. Where you intend to use the premises to be open to the members and guests at different times from those listed in the column on the left, list below

For example (but not exclusively), where you wish the activity to go on longer on a particular day e.g. Christmas Eve.

Section 18 of 19

LICENSING OBJECTIVES

Describe the steps you intend to take to promote the four licensing objectives:

a) General – all four licensing objectives (b,c,d,e)

List here steps you will take to promote all four licensing objectives together.

All managers are trained to be vigilant and to make regular checks. Managers will also liaise with security in the centre and also the local police and crime prevention team.

b) The prevention of crime and disorder

The centre has both security guards and CCTV.

c) Public safety

Managers are trained to be aware of acceptable social behaviour. Duty managers will work close with security to ensure public safety.

d) The prevention of public nuisance

We as a company take the responsibility of selling alcohol very seriously. All managers will be trained on challenge 25 and how to implement it.

e) The protection of children from harm

Again challenge 25 will be adhered to at all times. Staff will be trained to only accept passport, government approved ID cards or driving licence.

Continued from previous page...

Section 19 of 19

PAYMENT DETAILS

This fee must be paid to the authority. If you complete the application online, you must pay it by debit or credit card. Premises Licence Fees are determined by the non-domestic rateable value of the premises. Please see <http://www.stedmundsbury.gov.uk/sebc/live/pdf/licensing/PremFeesRev.pdf> for more information.

To find out a premises non domestic rateable value go to the Valuation Office Agency site at http://www.voa.gov.uk/business_rates/index.htm

- Band A - No RV to £4300 £100.00
- Band B - £4301 to £33000 £190.00
- Band C - £33001 to £8700 £315.00
- Band D - £87001 to £12500 £450.00*
- Band E - £125001 and over £635.00*

In all other cases, the premises shall be in Band A (i.e where NNDR does not apply) except where the premises is under construction, in which case it shall be in Band C.

*If the premises rateable value is in Bands D or E and the premises is primarily used for the consumption of alcohol on the premises then you are required to pay a higher fee

- Band D - £87001 to £12500 £900.00
- Band E - £125001 and over £1,905.00

There is an exemption from the payment of fees in relation to the provision of regulated entertainment at church halls, chapel halls or premises of a similar nature, village halls, parish or community halls, or other premises of a similar nature. The costs associated with these licences will be met by central Government. If, however, the licence also authorises the use of the premises for the supply of alcohol or the provision of late night refreshment, a fee will be required.

Schools and sixth form colleges are exempt from the fees associated with the authorisation of regulated entertainment where the entertainment is provided by and at the school or college and for the purposes of the school or college.

If you operate a large event you are subject to ADDITIONAL fees based upon the number in attendance at any one time

- Capacity 5000-9999 £1,000.00
- Capacity 10000-14999 £2,000.00
- Capacity 15000-19999 £4,000.00
- Capacity 20000-29999 £8,000.00
- Capacity 30000-39000 £16,000.00
- Capacity 40000-49999 £24,000.00
- Capacity 50000-59999 £32,000.00
- Capacity 60000-69999 £40,000.00
- Capacity 70000-79999 £48,000.00
- Capacity 80000-89999 £56,000.00
- Capacity 90000 and over £64,000.00

* Fee amount (£)

DECLARATION

* I/we understand it is an offence, liable on conviction to a fine up to level 5 on the standard scale, under section 158 of the licensing act 2003, to make a false statement in or in connection with this application.

Ticking this box indicates you have read and understood the above declaration

This section should be completed by the applicant, unless you answered "Yes" to the question "Are you an agent acting on behalf of the applicant?"

* Full name

* Capacity

Continued from previous page...

* Date

07	/	10	/	2015
dd		mm		yyyy

Add another signatory

Once you're finished you need to do the following:

1. Save this form to your computer by clicking file/save as...
2. Go back to <https://www.gov.uk/apply-for-a-licence/premises-licence/st-edmundsbury/apply-1> to upload this file and continue with your application.

Don't forget to make sure you have all your supporting documentation to hand.

IT IS AN OFFENCE, LIABLE ON SUMMARY CONVICTION TO A FINE NOT EXCEEDING LEVEL 5 ON THE STANDARD SCALE, UNDER SECTION 158 OF THE LICENSING ACT 2003, TO MAKE A FALSE STATEMENT IN OR IN CONNECTION WITH THIS APPLICATION

OFFICE USE ONLY

Applicant reference number	<input type="text"/>
Fee paid	<input type="text"/>
Payment provider reference	<input type="text"/>
ELMS Payment Reference	<input type="text"/>
Payment status	<input type="text"/>
Payment authorisation code	<input type="text"/>
Payment authorisation date	<input type="text"/>
Date and time submitted	<input type="text"/>
Approval deadline	<input type="text"/>
Error message	<input type="text"/>
Is Digitally signed	<input type="checkbox"/>

< Previous 1 2 3 4 5 6 7 8 9 10 11 12 13 14 15 16 17 18 19 Next >

St Edmundsbury Borough Council

Consent of individual to being specified as premises supervisor

I, JAMIE CONSTABLE
[full name of prospective premises supervisor]

of ST LEONARDS ROAD,
IPSWICH.

[home address of prospective premises supervisor]

hereby confirm that I give my consent to be specified as the designated premises supervisor in relation to the application for

SALE OF ALCOHOL
[type of application]

by LAMEN REDDY
[name of applicant]

relating to a premises licence *[number of existing licences, if any]*

for CPL FOODS LTD,
DELTA 1, MASTERBRO OFFICE VILLAGE,
WEST ROAD,
IPSWICH
IP3 9FH.

[name and address of premises to which the application relates]

and any premises licence to be granted or varied in respect of this application made by

LAMEN REDDY (CPL FOODS LTD)
[name of applicant]

concerning the supply of alcohol at

BURGER KING,
53 ST ANDREWS ST SOUTH
BURY ST EDMUNDS
IP33 1SD.

[name and address of premises to which application relates]

I also confirm that I am applying for, intend to apply for or currently hold a personal licence, details of which I set out below.

Personal licence number

IPS/201408457
[insert personal licence number, if any]

Personal licence issuing authority

IPS NCA
[insert name and address and telephone number of personal licence issuing authority, if any]

Signed.....

Name (please print)..... JAMIE CONSTABLE

Date..... 7/10/15

LAYOUT

St Andrews Street South

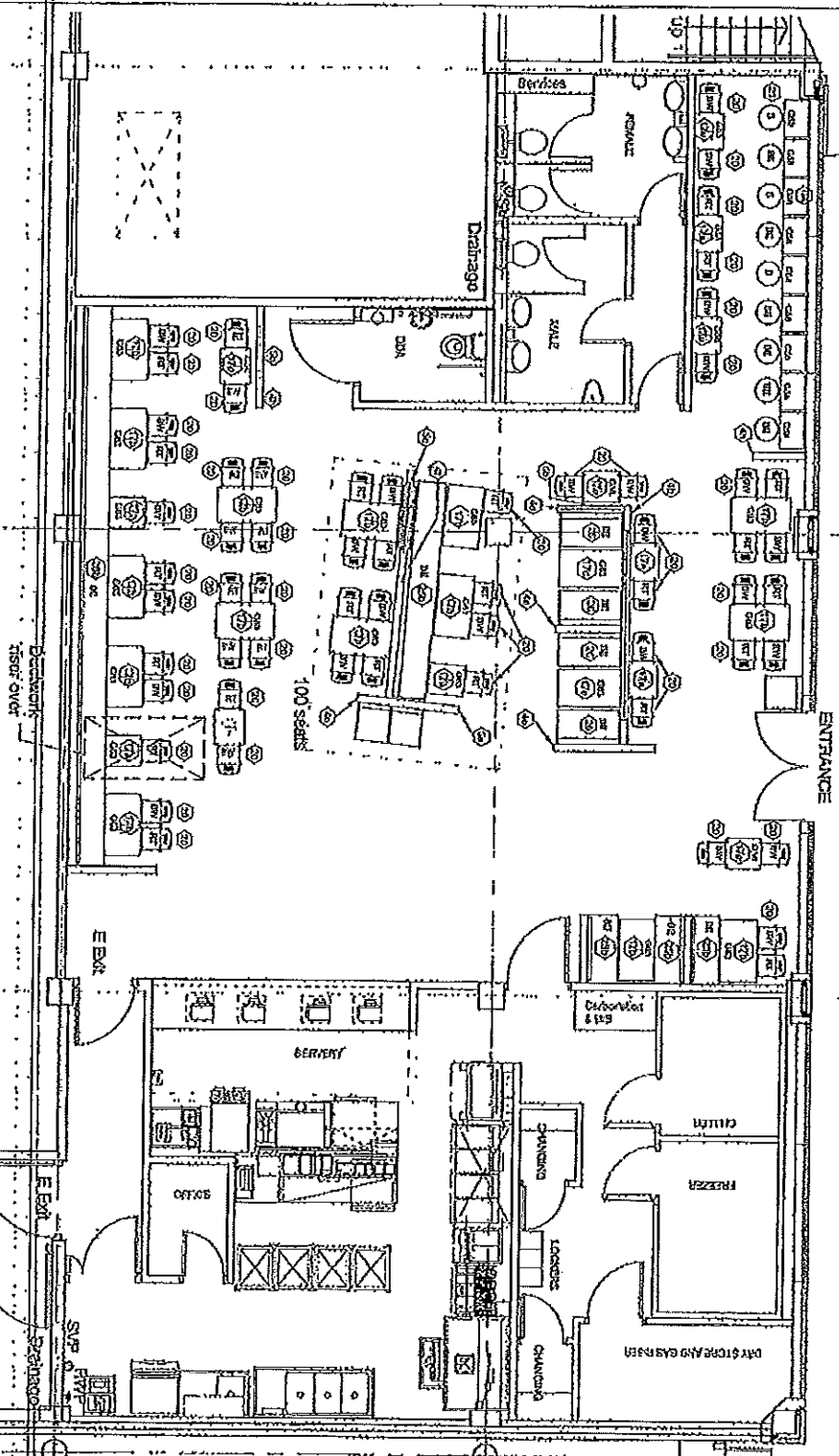

BURGER KING - BURY ST EDMUNDS

DESIGN

THIS DOCUMENT IS THE PROPERTY OF BYRSON DESIGN AND SHOULD NOT BE REPRODUCED OR TRANSMITTED IN ANY FORM OR BY ANY MEANS, ELECTRONIC OR MECHANICAL, INCLUDING PHOTOCOPYING, RECORDING, OR BY ANY INFORMATION STORAGE AND RETRIEVAL SYSTEM. ANY UNAUTHORIZED USE OF THIS DOCUMENT IS PROHIBITED. BYRSON DESIGN ACCEPTS NO LIABILITY FOR ANY DAMAGE OR LOSS OF PROFITS, BUSINESS, OR REPUTATION, OR FOR ANY SPECIAL, INCIDENTAL, OR CONSEQUENTIAL DAMAGES, INCLUDING LOST PROFITS, ARISING OUT OF OR IN CONNECTION WITH THE USE OF THIS DOCUMENT.

AREA FOR FOOD TO EXHIBIT
 AREA FOR FOOD TO EXHIBIT
 AREA FOR FOOD TO EXHIBIT
 AREA FOR FOOD TO EXHIBIT

Project: BURGER KING BURY ST EDMUNDS
 Drawing No: LAYOUT 2020 LIGHT
 Date: 10/20/20

byrischt design
 Architects and Interior Designers
 1499 D. J. S. 2017 S.
 1499 D. J. S. 2017 S.

